

DE

Technische Unterlagen

Ökodesignverordnung

EN

Technical Documents

Ecodesign Regulation



MIG 192/6K Schutzgas-Schweissgerät

20076

1

DE

Materialliste

EN

Bill of materials



MIG 192/6K # 20076

Bitte beachten Sie, dass die Zeichnung und Stückliste nicht für die Ersatzteilbestimmung angedacht sind.

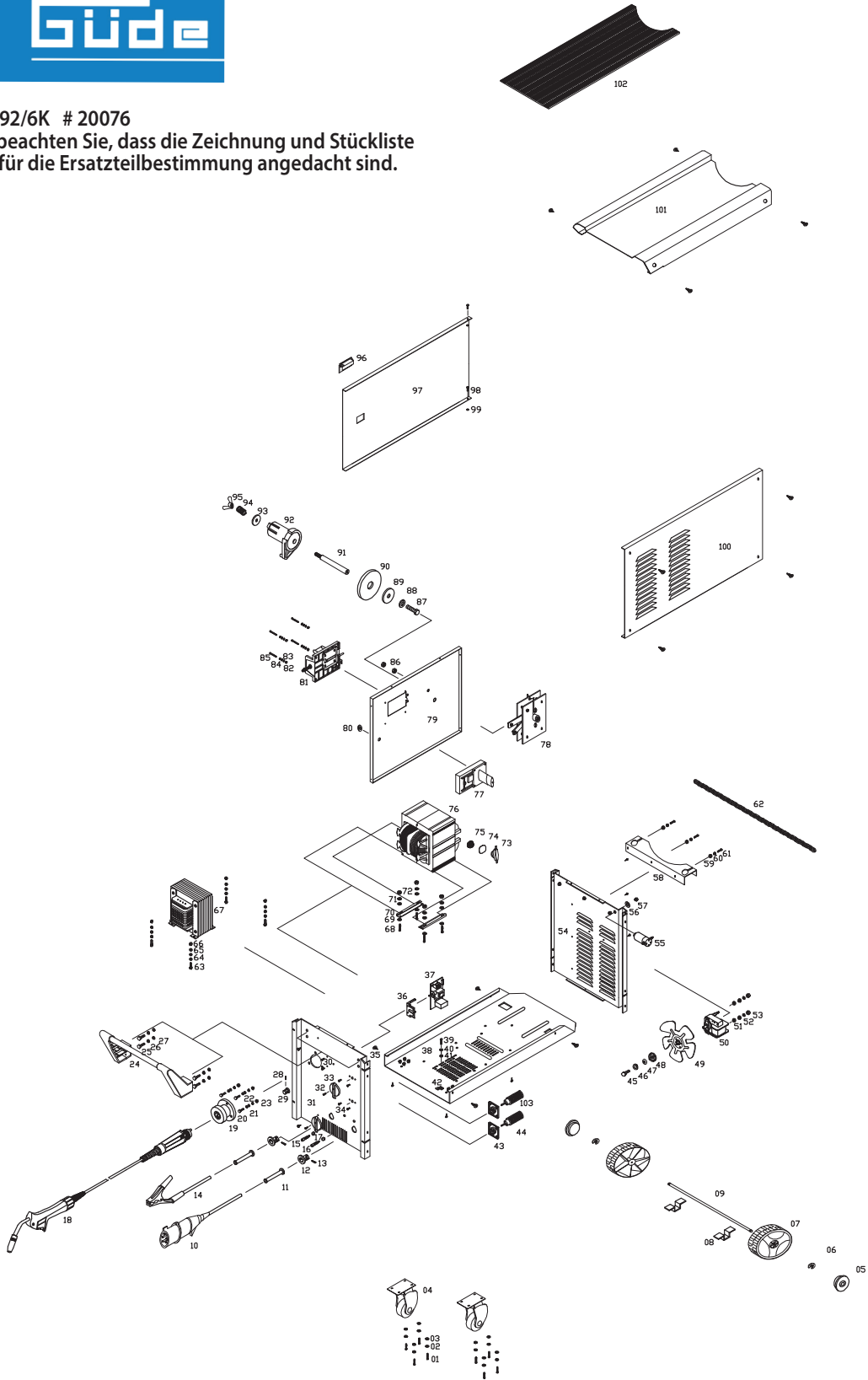

Schutzgas-Schweißgerät MIG 192/6 K



MIG 192/6 K
20076

No	Name	Specifications	Unit	Qty	Material No.	remark
1	fixup screw	M6X12	pc	8		40g
2	Flat washer	Φ6	pc	8		
3	Spring washer	Φ6	pc	8		
4	universal wheel	65mm	pc	2		688g
5	Cover of wheel	PP	pc	2		96g
6	Clip	Q215	pc	2		1g
7	Wheel	PP	pc	2		172g
8	Bracket of axle	Q215	pc	2		26g
9	Axle	45# Φ8×350mm	pc	1		150g
10	industrial plug	KCD-101 16A IP44 PA66 H07RN-F 4G1.5mm ²	pc	1		167+633g
11	Jacket of cable		pc	2		16g
12	Lock stud	PVC	pc	2		9g
13	Self-tapping round-head cross screw	M3×12	pc	2		1g
14	earth clamp	KDC-1250	pc	1		108g
15	Power indicator light	AD-16W-2 AC 400V M10	pc	1		1g
16	Over-heat indicator light	AD-16Y-2 AC 400V M10	pc	1		1g
17	Fixup screw of indicator light	M10	pc	2		1g
18	MIG torch	KDH-8350 280A 35%	set	1		1850g
19	socket of torch		set	1		300g
20	Screw	M5×20	pc	3		10g
21	Flat washer	Φ5	pc	6		3g
22	Spring washer	Φ5	pc	3		0.2g
23	Nut	M5	pc	3		3g
24	Handle		set	1		230g
25	Screw	M6×12	pc	4		16g
26	Spring washer	Φ6	pc	4		2g
27	Flat washer	Φ6	pc	4		2g
28	Screw	M4X5	pc	1		2g
29	Potentiometer knob		pc	1		7g
30	Fixup screw	M4X10 Self-tapping	pc	4		1g
31	Front panel	Q215	set	1		907g
32	screw	M3X6 round head	pc	2		0.2
33	Knob of switch		pc	2		4g
34	Screw	M4X12 flat head crossed	pc	4		2g

No	Name	Specifications	Unit	Qty	Material No.	remark
35	Self-tapping screw	M4X10	pc	20		1g
36	Bracket of circuit board		pc	1		14g
37	PCB		set	1		326g
38	motherboard	Q215	set	1		1798g
39	earth ccrew	M4X10	pc	1		1.2g
40	Spring washer	Φ4	pc	1		0.2g
41	dentiform washer	Φ4	pc	1		0.3g
42	earth set	Q215	pc	1		3g
43	washer		pc	2		6g
44	shelves switch	HZ8B-20/3/4	pc	1		149g
45	screw	M4X14	pc	1		1g
46	Spring washer	Φ4	pc	1		0.3g
47	Flat washer	Φ4	pc	1		0.4g
48	base of fan leaves		pc	1		3g
49	fan leaves	Φ150	pc	1		50g
50	fan motor	YZF-2-30 230/400V 50HZ 30W	pc	1		591g
51	Flat washer	Φ4	pc	4		2g
52	Spring washer	Φ4	pc	2		0.4g
53	nut	M4	pc	2		2g
54	back panel	Q215	set	1		961g
55	electromagnetic valve	DC24V	pc	1		200g
56	washer	Φ10	pc	1		1g
57	nut	M10	pc	1		1g
58	bracket of gas bottle	Q215	pc	1		274g
59	Flat washer	Φ6	pc	3		1.5g
60	Spring washer	Φ6	pc	3		1.5g
61	screw	M6X12	pc	3		3g
62	chain of gas bottle	45#	centi-meter	80		176g
63	screw	M5X12 hexagon crossed	pc	4		8g
64	Flat washer	Φ5	pc	8		4g
65	Spring washer	Φ5	pc	4		0.2g
66	Nut	M5	pc	4		4g
67	reactance		pc	1		4116
68	screw of transformer	M5X20hexagon crossed	pc	4		14g
69	Flat washer	Φ5	pc	8		4g
70	bracket of transformer	Q215	pc	2		174g
71	Spring washer	Φ5	pc	4		0.2g
72	Nut	M5	pc	4		4g
73	Thermal protection	KDS-R302 128°C 32A	pc	1		18g
74	cooling fin	27x27x1	pc	1		0.5g
75	daub		gram	50		0.5g

No	Name	Specifications	Unit	Qty	Material No.	remark
76	Main transformer		pc	1		12795g
77	wire feeding motor	KD241 24V 0.4A	pc	1		490g
78	rectify bridge	180A	pc	1		393g
79	Clapboard	Q215	set	1		1219g
80	Washer	rubber	pc	1		1g
81	wire feeding mechanism	PA66	set	1		208g
82	Nut	M4	pc	4		4g
83	Spring washer	Φ4	pc	4		4g
84	Flat washer	Φ4	pc	8		4g
85	Screw	M4X16	pc	4		4g
86	screw	M8	pc	2		2g
87	screw	M10X20 hexagon head	pc	1		1g
88	Spring washer	Φ10	pc	1		1g
89	small mat		pc	1		24g
90	big mat		pc	1		29g
91	axle for wire-feed spool	1/5kg	pc	1		19g
92	wire-feed spool	5kg	pc	1		170g
93	Flat washer	Φ10	pc	1		1g
94	Spring	Φ1.5x30	pc	1		2g
95	butterfly nut	M10	pc	1		11g
96	botton		pc	1		10g
97	left-side panel	Q215	set	1		1092g
98	screw	M5X10	pc	2		2g
99	cap-type nut	M5	pc	2		2g
100	right-side panel	Q215	set	1		1097g
101	top board	Q215	set	1		1449g
102	rubber mat	510X180X3	pc	1		293g
103	switch	HZ8B-20/5/3	pc	1		149g

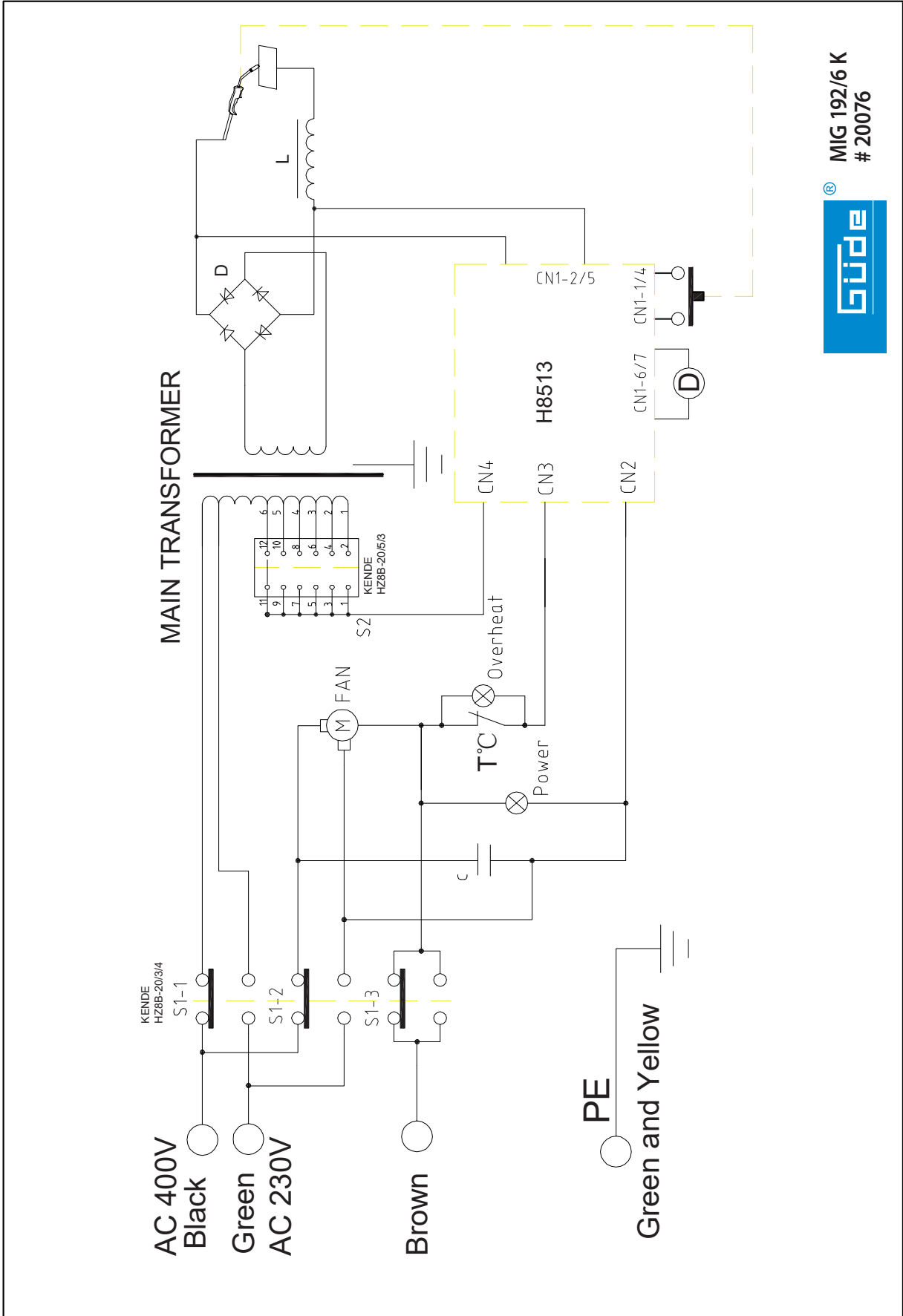

GÜDE GmbH & Co. KG
Birkichstrasse 6
74549 Wolpertshausen
Deutschland
Tel.: +49-(0)7904/700-0
Fax.: +49-(0)7904/700-250
eMail: info@guede.com

